

C Series

BLC1 - Purge Type

Features

- ⦿ Sampling from vacuum, low or high pressure devices or process lines
- ⦿ Sampling with a piston valve to ensure zero dead volume
- ⦿ Sampling for highly viscous liquids
- ⦿ Needle purge

Basic Configuration

Wetted Material	316 SS	
Sleeve Assembly	250 ml sleeve with bottle retaining clip	
Needle Assembly	Process/vent needle ID: 1.4 mm (0.06")	
Sampling Valve	Piston valve: PTFE seat Max. working pressure: 1500 psig @ 70°F (103 bar @ 20°C) Temperature range: 0°F to 450°F (-18°C to 232°C)	
Nitrogen Branch	Nitrogen regulator	
	CV Series check valves, NB Series needle valves	
	Pressure gauge	
Connections	Process: 1/2" MNPT	
	Vent/purge: 1/4" tube fitting	

Note: Products of other specifications are available upon request.

Typical Installation Mode

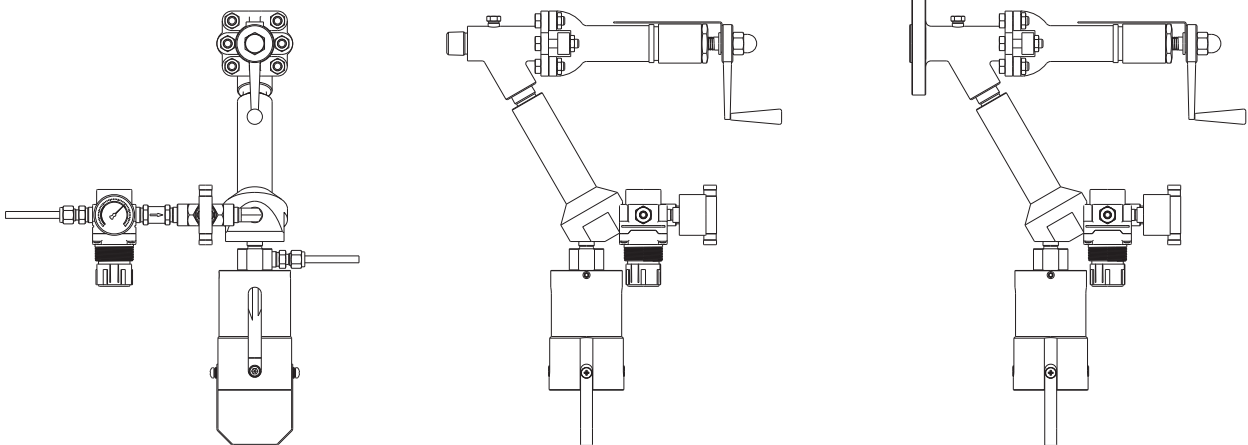

Operation

1 - Preparation

Place a new septum on the sample bottle. Insert the bottle with cap and septum into the sleeve until the septum is pierced by the needles. Swing down the bottle retaining clip.

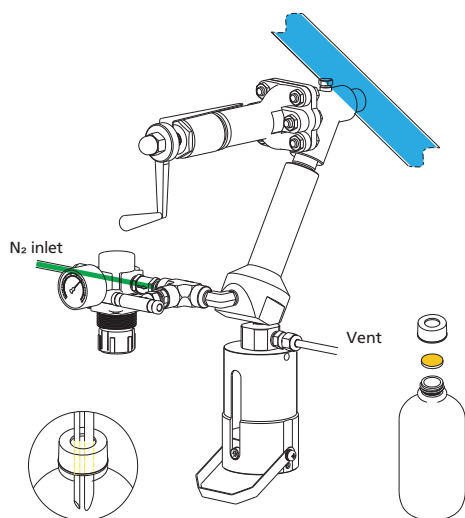

2 - Sampling

Open the piston valve, allowing the sample to flow into the bottle. When the required amount has been taken, close the piston valve.

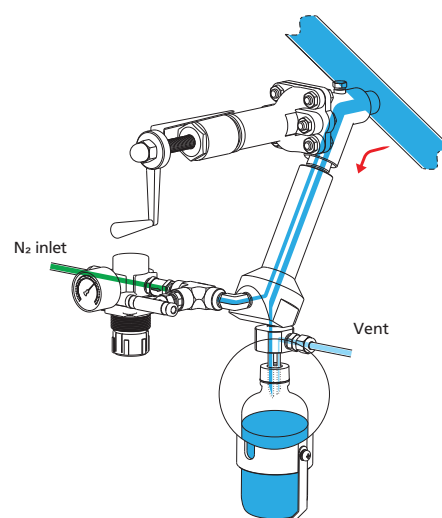

3 - Needle Purge

Open the valve on the Nitrogen branch, allowing Nitrogen to force the residual sample from the system into the bottle.

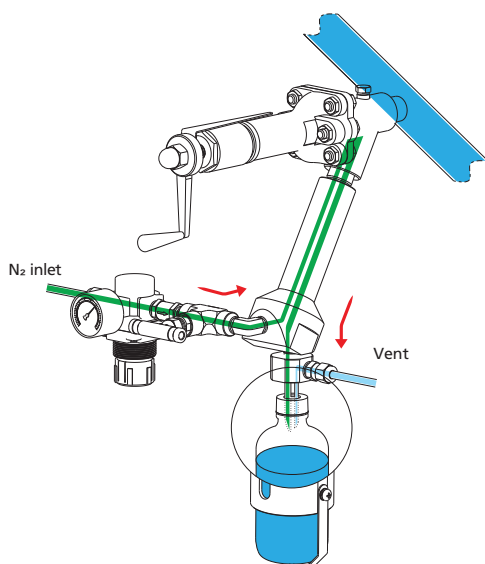

4 - Off

Close the valve on the Nitrogen branch. Remove the bottle retaining clip and take out the bottle from the sleeve. The septum reseals automatically to complete the sampling process.

