

BLC2 - Fixed Volume and Purge Type

Features

- ⦿ Sampling from vacuum, low or high pressure devices or process lines
- ⦿ Fixed volume sampling
- ⦿ Sampling with a piston valve to ensure zero dead volume
- ⦿ Sampling for highly viscous liquids
- ⦿ Needle purge

Basic Configuration

Wetted Material	316 SS	
Sleeve Assembly	250 ml sleeve with bottle retaining clip	
Needle Assembly	Process/vent needle ID: 1.4 mm (0.06")	
Sampling Valve	Piston valve: PTFE seat Max. working pressure: 1500 psig @ 70°F (103 bar @ 20°C) Temperature range: 0°F to 450°F (-18°C to 232°C)	
Nitrogen Branch	Nitrogen regulator	
	CV Series check valves, NB Series needle valves	
Connections	Pressure gauge	
	Process: 1/2" MNPT Vent/purge: 1/4" tube fitting	

Note: Products of other specifications are available upon request.

Typical Installation Mode

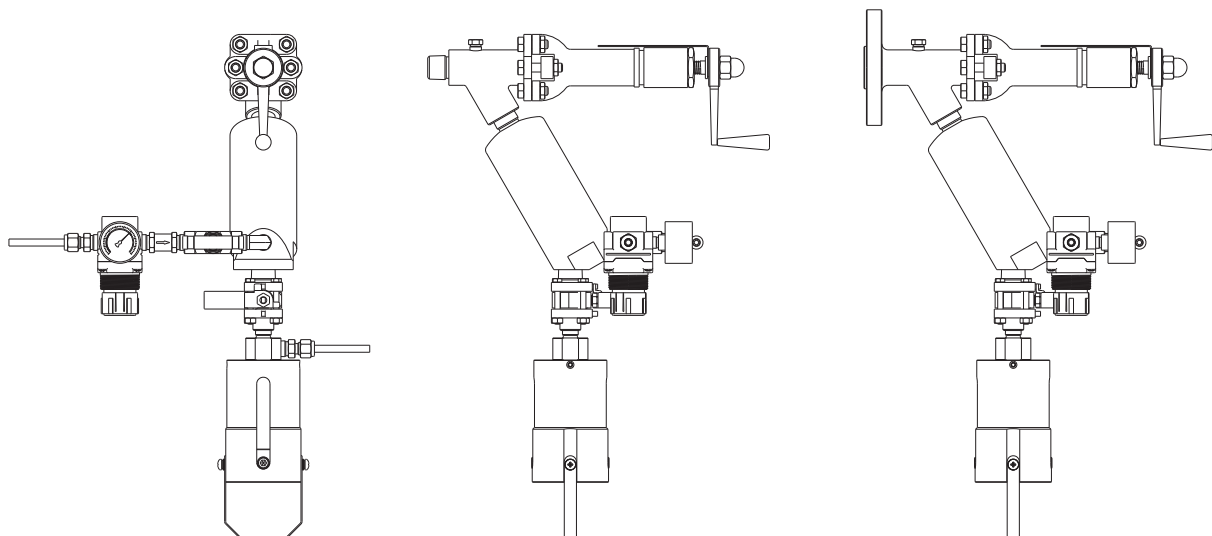

Operation

1 - Preparation

Place a new septum on the sample bottle. Insert the bottle with cap and septum into the sleeve until the septum is pierced by the needles. Swing down the bottle retaining clip.

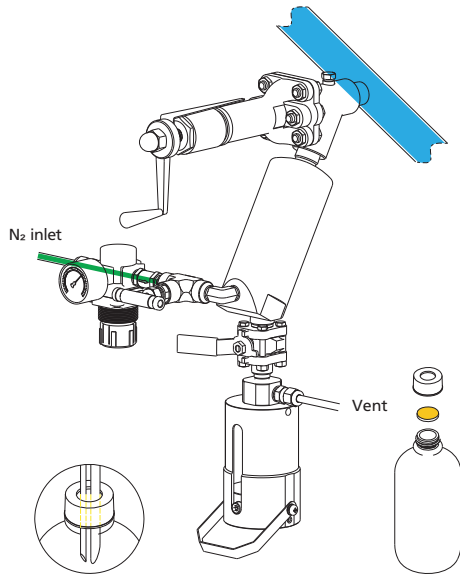

2 - Pre-sampling

Open the piston valve, allowing the sample to flow into the sample chamber. The amount of sample depends on the sample chamber volume and process pressure. Close the piston valve.

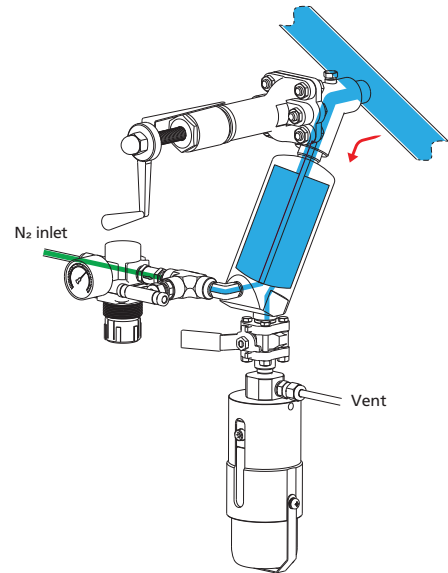

3 - Sampling

Open the valve on the Nitrogen branch and the valve above the needle assembly, allowing Nitrogen to force the sample from the sample chamber into the bottle and purge the system.

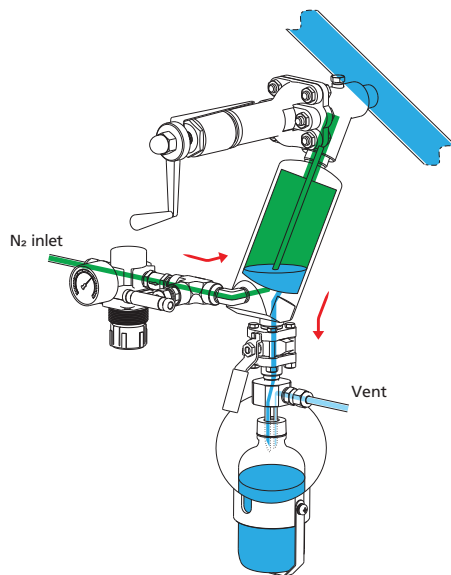

4 - Off

Close the valve on the Nitrogen branch and the valve above the needle assembly. Remove the bottle retaining clip and take out the bottle from the sleeve. The septum reseals automatically to complete the sampling process.

